

FORM NO. 1.

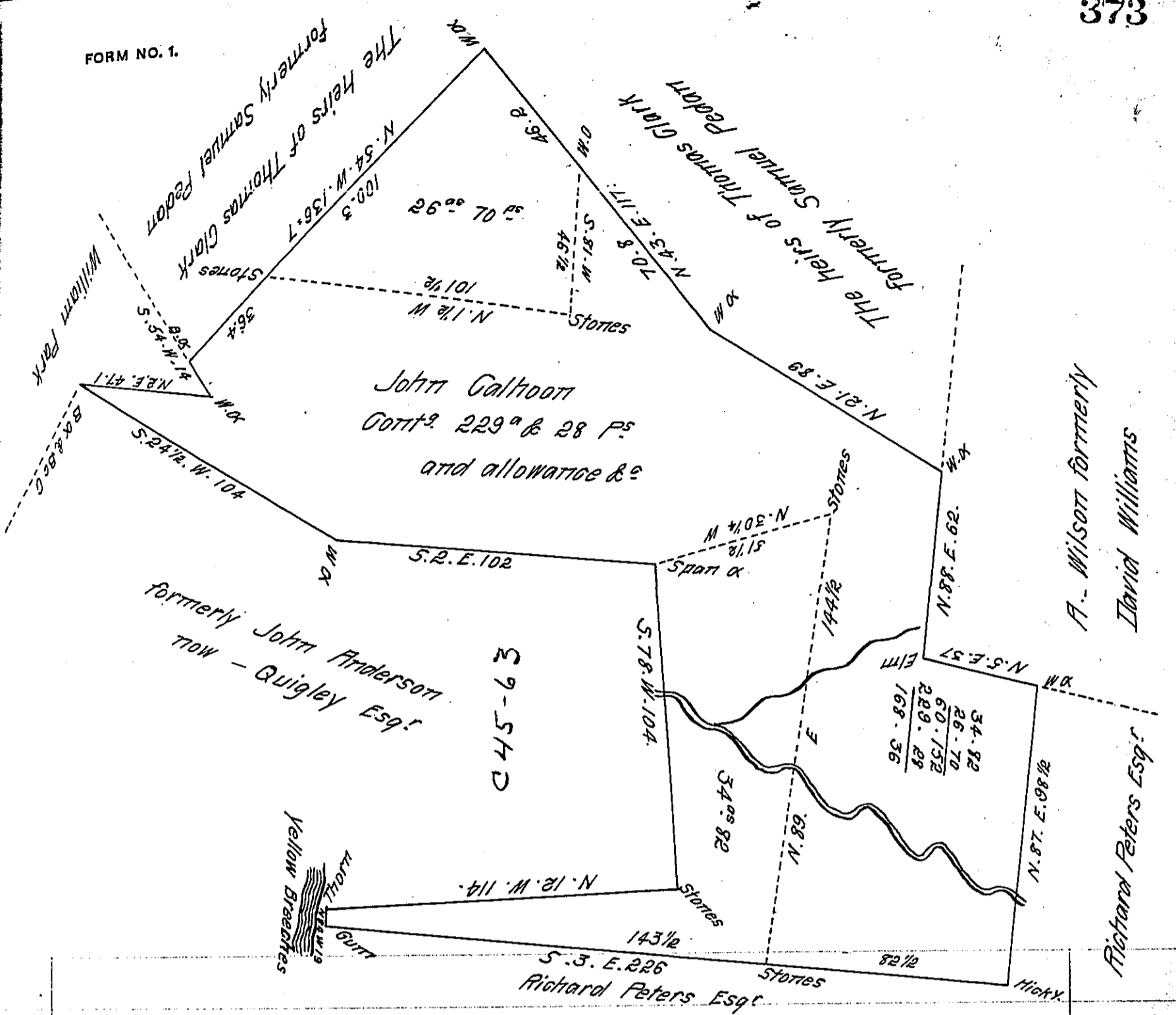

Situate in Manahan Township in the County of York containing as arobl  
 set forth 229° & 28' Perches and the usual allowance of six per Cent for Roads  
 &c Originally Surveyed by Lewis Lewis late Surveyor under Charles Lukens late D.S. on  
 the 18<sup>th</sup> day of March A.D. 1771. in Pursuance of the application N<sup>o</sup> 2100 Granted  
 to John Galkoot for - 100<sup>o</sup> bearing date the 5<sup>th</sup> day of December A.D. 1766.  
 Resurveyed by John Forsyth late D.S. in the Month of May 1799. And now at  
 the request of the different owners the same has been Calculated Examined  
 and found Correct and at their request Returned for Confirmation - the 29<sup>th</sup>  
 day of December A.D. 1814.

To Richard T. Leech Esq<sup>r</sup>  
 Surveyor General  
 Harrisburg Pa

Per  
 Jacob Spangler D.S.

IN TESTIMONY that the above is a copy of the original remaining on file in  
 the Department of Internal Affairs of Pennsylvania, made  
 conformably to an Act of Assembly approved the 16th day of  
 February, 1833, I have hereunto set my Hand and caused  
 the Seal of said Department to be affixed at Harrisburg,  
 this Seventh day of August 1911

*Henry Houck*  
 Secretary of Internal Affairs.